



Welcome to the world of

SAMKWANG



Company introduction

- 1. Company Overview
- 2. Management Philosophy
- 3. Company Strategy
- 4. SWOT
- 5. Company History
- 6. Company Organization
 - 6.1 Samkwang global presence
- 7. Gross Sales

Manufacturing introduction

- 8. Manufacturing Process
 - 8.1 Tooling
 - 8.2 Injection Molding
 - 8.3 Capacity
 - 8.4 Painting
 - 8.5 Heat Transfer/Pad Printing
 - 8.6 Laser etching
 - 8.7 Assembly line

Our Company

- 9. Facility Status & global presence
 - 10.1 National minority supplier in process
- 11. China SAMKWANG
- 13. Korea SAMKWANG
- 15. Our current customers & potential
- 17. Samkwang Reynosa Logistic
- 18. Tool Partner Capabilities (Korea), tooling design & Decorative/Chroming
- 20. Sales
- 10. Quality Control
 - 10.2 Metrology & test facilities
- 12. Vietnam SAMKWANG
- 14. Product Introduction 2019
- 16. Our products in Reynosa
- 19. Advantages of Samkwang in Reynosa

1. Company Overview



Continuously striving to anticipate ,meet and exceed all customer requirements



Samkwang has been established at Reynosa Mexico since 2005 with a clear mission to be focus 100% Customer providing services from top quality facilities, technological know-how, and competent human talent. Through incessant creation and innovation, we are intent on becoming one of the top ranking technology companies of the world.

MEXICO	SAMKWANG AUTOMOTIVE Co.,Ltd.	Sales Amount	7.8 M USD (2018)
--------	------------------------------	--------------	------------------

KOREA	SAMKWANG AUTOMOTIVE Co.,Ltd.	Sales Amount	300 M USD (2018)
-------	------------------------------	--------------	------------------

VIETNAM (New company 2018 founded)	SAMKWANG AUTOMOTIVE Co.,Ltd.	Sales Amount	New company(less 1 year)
--	------------------------------	--------------	--------------------------

CHINA	SAMKWANG AUTOMOTIVE Co.,Ltd.	Sales Amount	440 M USD (2018)
-------	------------------------------	--------------	------------------

2. Management Philosophy



Vision

- ***A strong foundation of Core Competences, serving a Global Market, with World Class Performance in Delivering Value-added Services***

Behavioral Norm

- ***Ownership***
- ***Persistency to achieve goals***

Core Values

- ***Human Talent***
Provides equal opportunity for everyone on the belief that 'People are the Key.' We believe in treating our customers with respect and faith
- ***Emphasis on Fundamental***
We integrate honesty, integrity and business ethics into all aspects of our business functioning
- ***On-site Oriented***
On the basis of 3 On-site Principles (On the site, On-site observation, On-site grasping) everyone is urged to solve problems on site.
- ***Technology First***
Driving force for future will be sought through automation and development of new technologies.
- ***Differentiation***
Differentiate in product and technology to remain competitive at all time.

3. Company Strategy



Based on our core capability, SAMKWANG has a plan to expand its business into diverse products and materials as an expert company.

Products Diversification

Expanding into automotive, Cosmetics, home-appliance, and medical equipment field



Autonomous, robotics & singularity



Materials Diversification(Korea/China)

Expanding to such material field as urethane, silicone, metal, glasstic & electronics

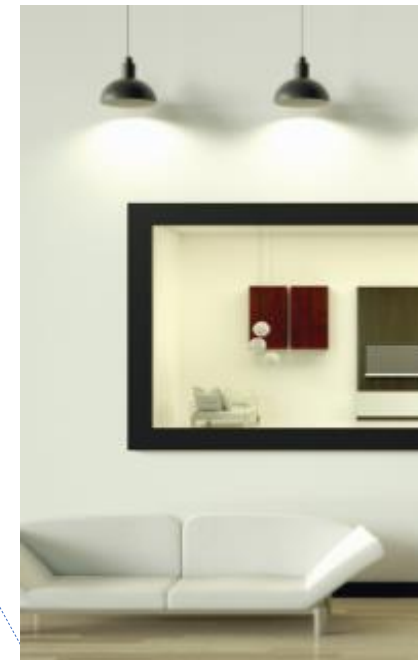

4. SWOT

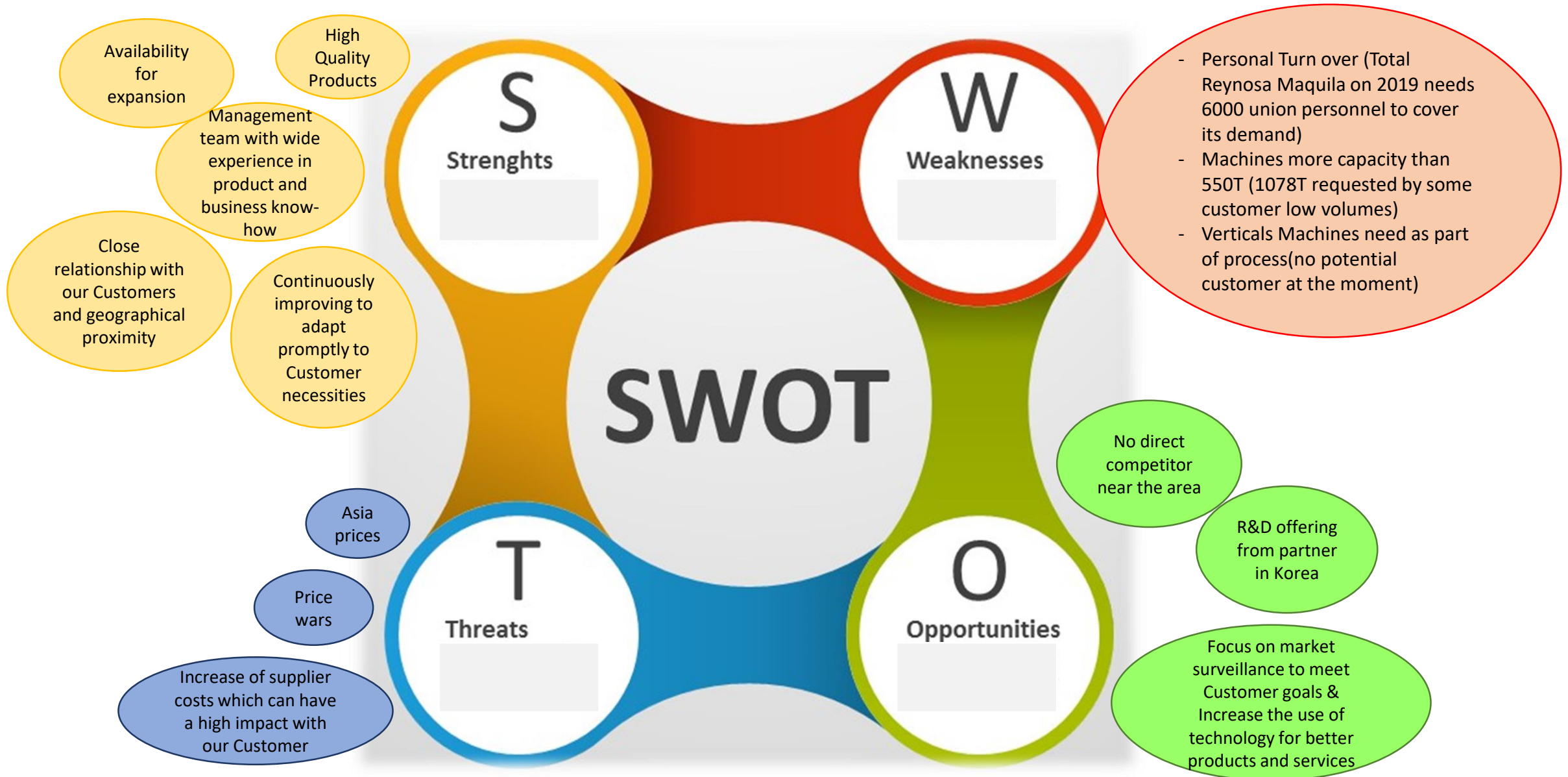

5. Company History

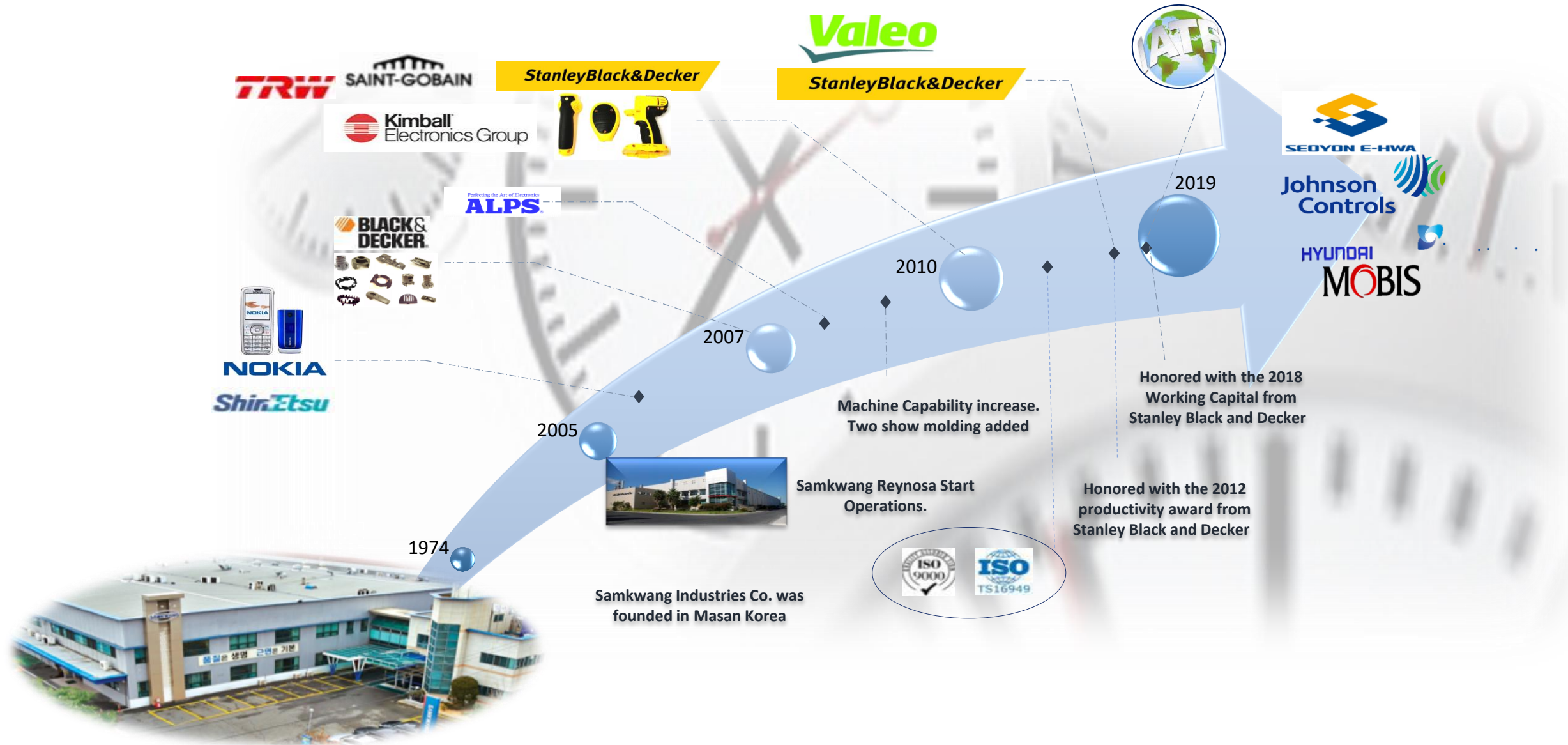

6. Company Organization

On the strength of process improvements know-how and product quality, Samkwang is growing into business

Green belt certification
September 2019



VSM certification September 2019



6.1 Samkwang global presence

Korea	845
China	4,870
Vietnam	1,374
Mexico	190
USA	1
Total	7,280

I

IT

A

Automotive

T

Tool

R

R & D

M

Medical

C

Cosmetics

CEO

6. Company Organization

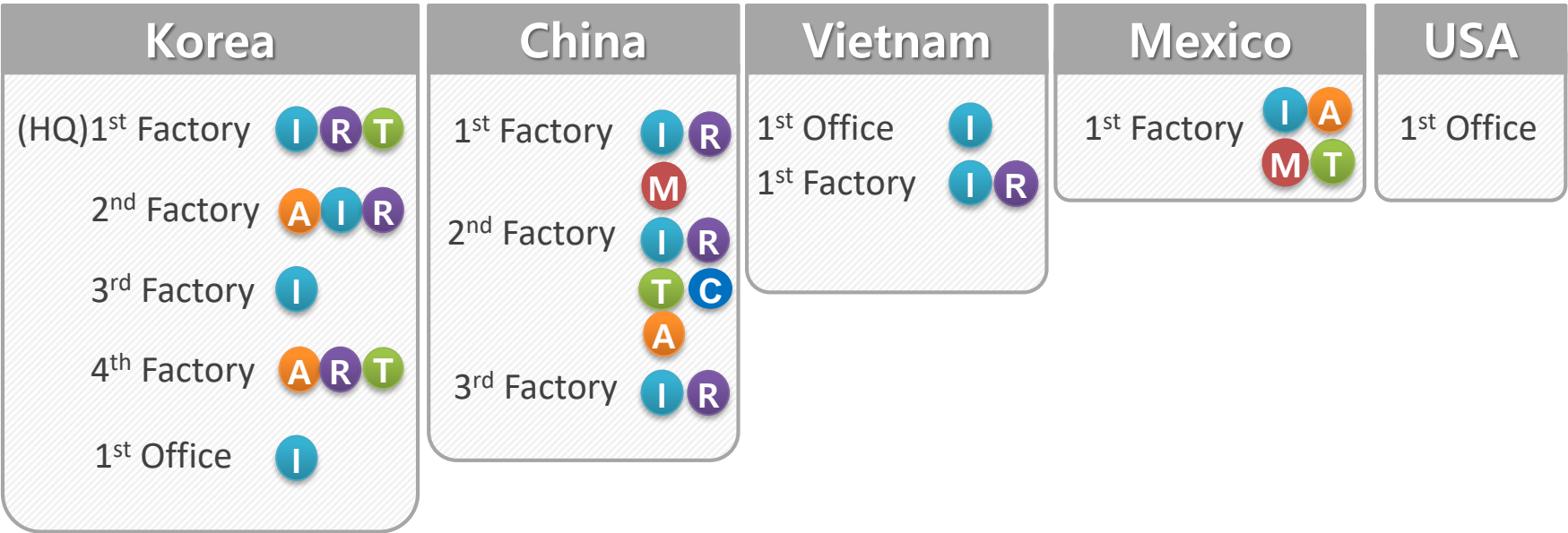

7. Gross Sales



Unit : M USD

CAGR(Compound Annual Growth Rate) / Included overseas sales.

CAGR 23.9%

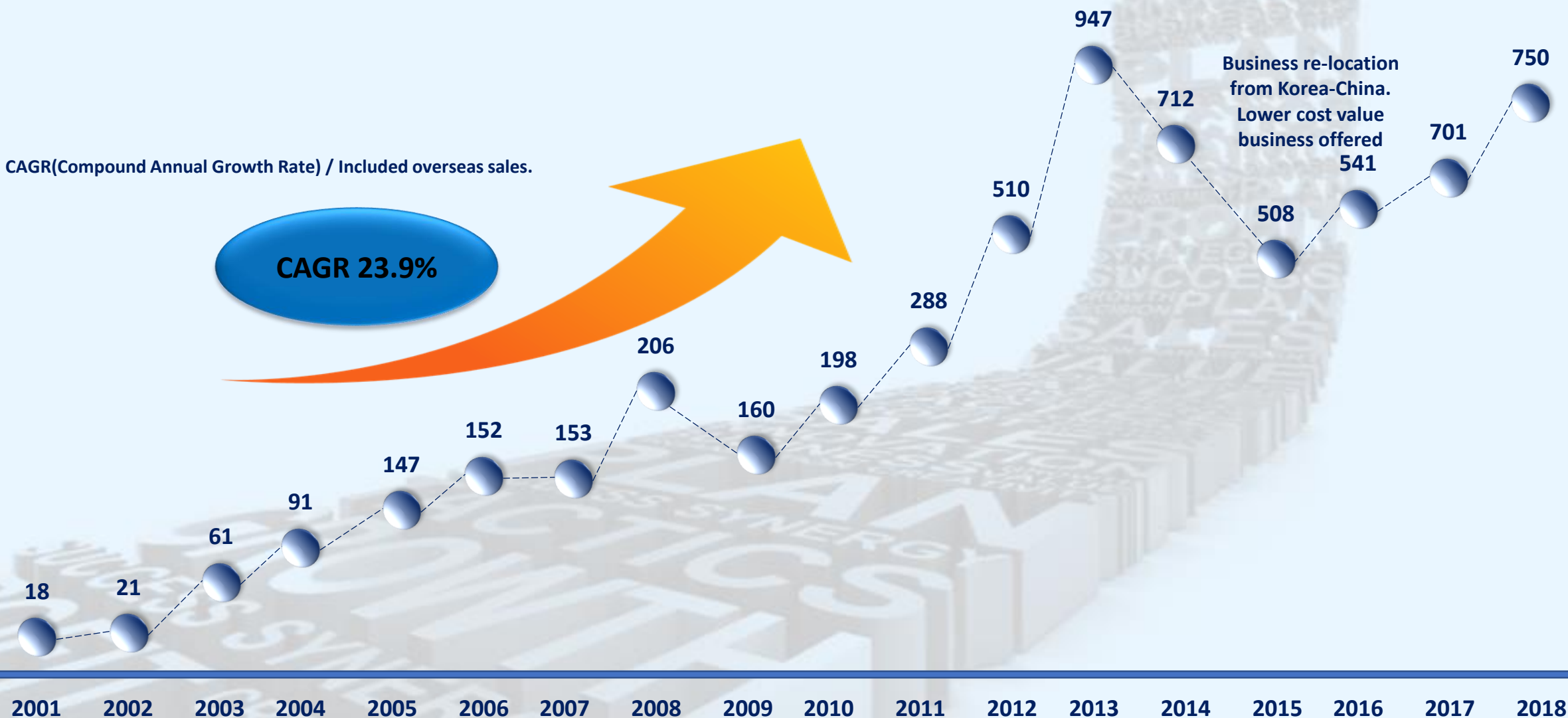

8. Manufacturing Process

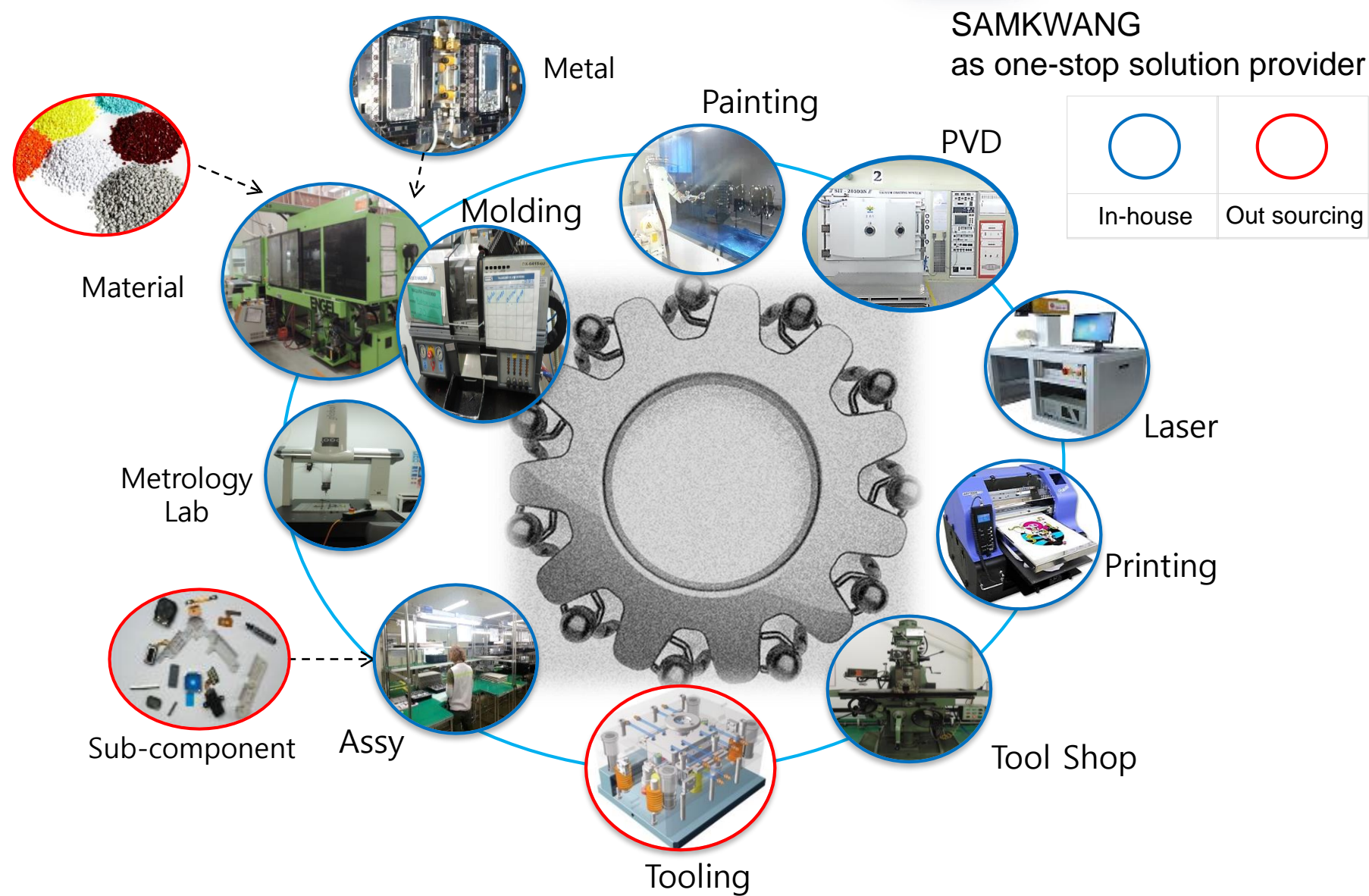

8.1 Tooling



On the basis of accumulated processing technology and know-how from general-use to precision facility, Samkwang realizes processing of quality precision products and implements diverse molding injection and patterns.

We provide solutions that can solve problems as they occur in injection process through accumulated knowledge, from the design stage to stable mass production.

Equipment Status

- ❖ EDM CNC
 - ❖ Conventional EDM
 - ❖ Die Posting Machine
 - ❖ EDM Drill
 - ❖ Mig, Tig& Laser Weld Machine
 - ❖ CNC Milling Machine
 - ❖ Conventional Milling Machine
 - ❖ NC Wire EDM
 - ❖ Lathe
- ❖ Grande Machine
 - ❖ Height Gauge
 - ❖ Eng. Change / Repairing
 - ❖ Go-No Go gages, Poka-yokes
 - ❖ New Tool capability via Korean partnerships.

CNC-RXP 500



IDN-Robo form 350



Regular lathe



Regular milling machine



Wire or thread cutter machine



Manual IDM



8.2 Injection Molding

With state-of-the-art injection facility, we have technological capability for injection control and superb reproducibility as well as quality and cost competitiveness through unmanned automation system.

We can meet specifications desired by our clients using plastic injections for prompt production with the capacity for reproducibility and mass-production capacity. On the strength of on-going R&D and specialized know-how for injection of mobile phones, we have competitiveness in productivity and cost thanks to our unmanned automation system. We ensure quality products with bold investments in injection clean-room and optimum work environment.

Equipment Status

6T (Baby Plast) Qty= 3		
70 Hydraulic Qty=1		
80T Hydraulic Qty=1		
150 Hydraulic Qty= 15		
180 T Electric Qty= 3		
220T Hydraulic Qty=5		
240 Electric Qty=1		
300T Hydraulic Two shots Qty=4		
350T Electric Qty=1		
350T Hydraulic Qty=2		
450 Hydraulic Qty=2		
550T Hydraulic Qty=2		
550 Electric Qty=1		
250	(Hybrid)	1
310	Electric	1
350	(Hybrid)	1
1080	(Hybrid)	1

Expansion of 4 new machines (3rd quarter FY20)



- ❖ Primarily based on Engel machine
- ❖ Expansion availability
- ❖ 40 Machines



8.3 Capacity

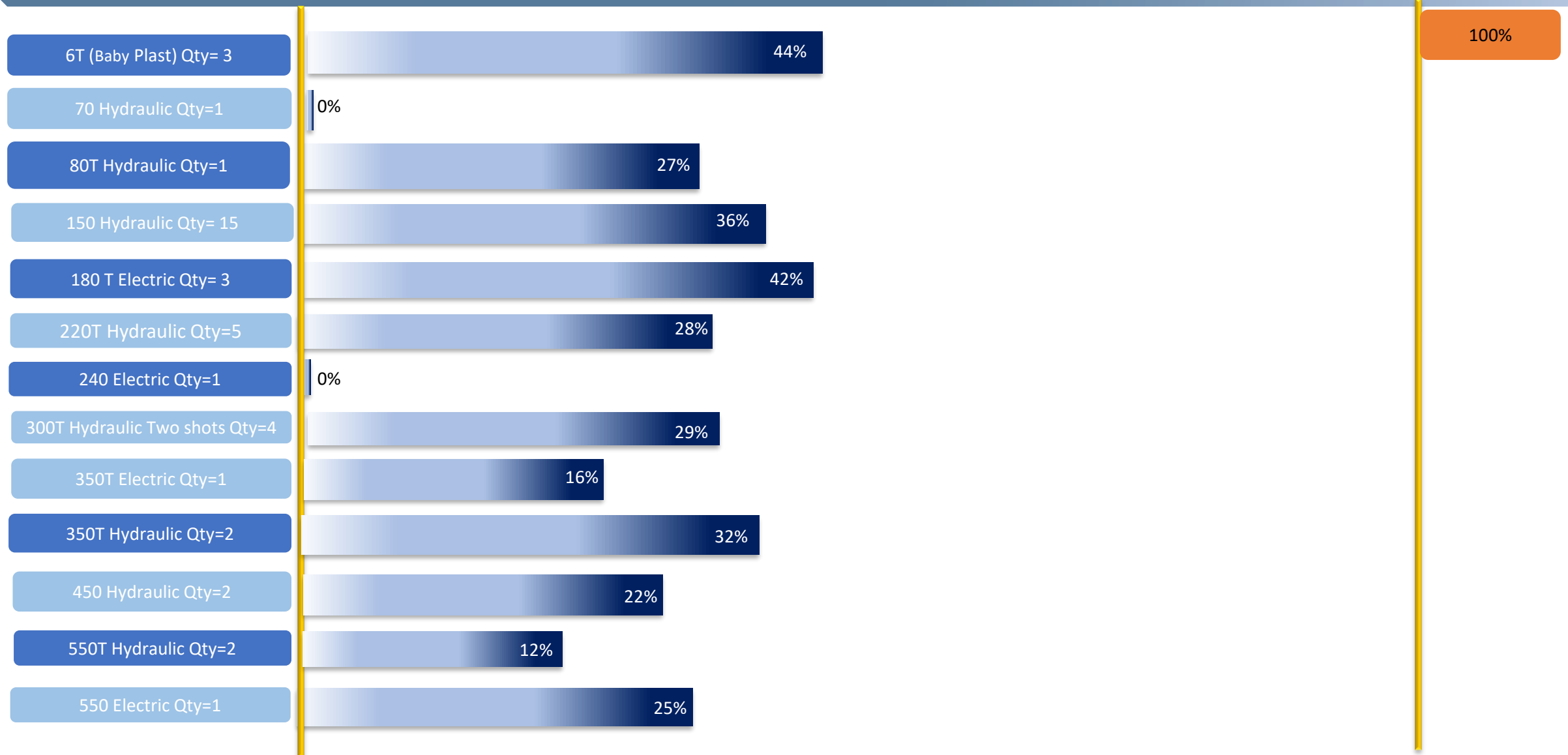

8.4 Painting

We are in possession of world-class technology and unmanned automation system that can implement diverse coating patterns.

We can implement both spindle method and X-Y method of coating to go with our auto process system that can minimize defects in coating process.

- ❖ Flat Surface Painting (X-Y Paint Lines)
- ❖ Irregular Surface Painting (Spindle Paint Lines)
- ❖ Piano Black
- ❖ Top UV coating

Equipment Status and Technology



XY method



8.5 Heat Transfer/Pad Printing

We are in possession of world-class technology and unmanned automation system that can implement diverse coating patterns.

Equipment Status

- ❖ Pad Printing
- ❖ Heat Transfer

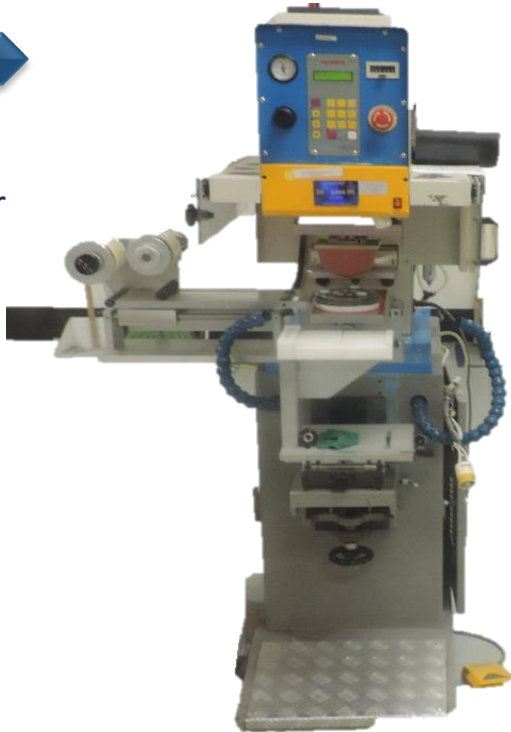

Pad printing

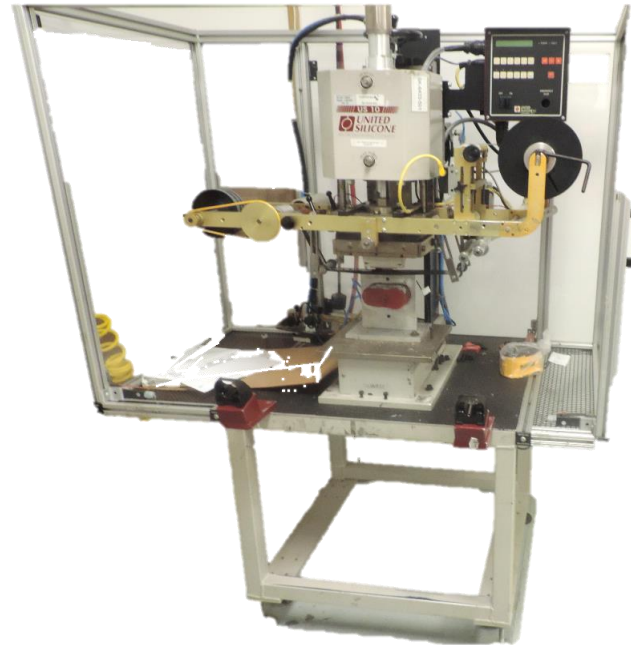

Heat transfer

8.6 Laser etching

Applying the principle of intaglio-type marking using different wave lengths and energy, we are implementing diverse forms of marking on the surface of various materials such as logo, trade mark, letters, and pictures.

We are in possession of state-of-the-art Fiber laser equipment that has a function to transform unique colors using instant chemical reactions that do not damage surfaces. Our equipment is very beneficial in reinforcing durability of product quality with specialize technologies for stabilization of TSP tapes and removal of flaws in coating. The technology can be applied to such fields as plastic injection, materials for auto interior, eye-glass frame, medical instruments, and precious metal marki



Fiber laser



Key FOB



Center Fascia

We implement assembly work of complex and precise plastic parts through construction of automation line perfectly if is required, and realize customer delight through epoch-making productivity and the highest quality.

We have secured technological capacity to assemble diverse plastic parts through stable operation of experienced workers on assembly line and respond to quality and delivery requests from our clients through construction of automation lines, streamlining the assembly process of complex plastic parts based on accumulated know-how in years of manufacturing process, we are maximizing efficiency through optimization of processing equipment and process.



9. Facility status & global presence

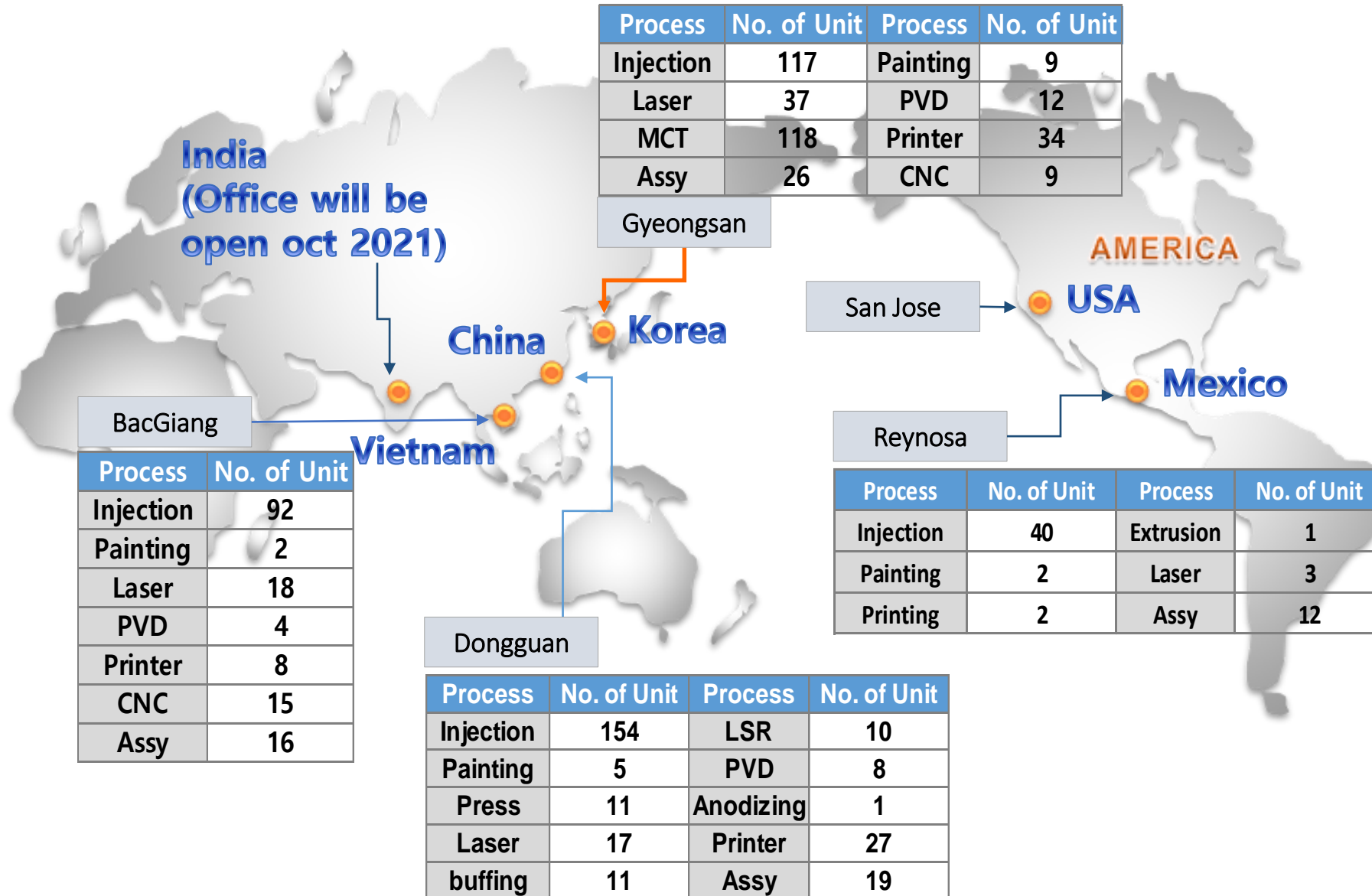

10. Quality Control



By maximizing customer satisfaction, stabilizing development quality, and 100% achievement of standard perfection ratio through process control, we are concentrating all our efforts on realizing customer satisfaction through world-class quality and services.

Quality Assurance Process (IPO System)

Quality assurance process consists of 3 stages of IPO, and competitiveness is reinforced by repetitive implementation of IPO. * IPO: IN-PUT QUALITY, PROCESS QUALITY, OUT-PUT QUALITY)

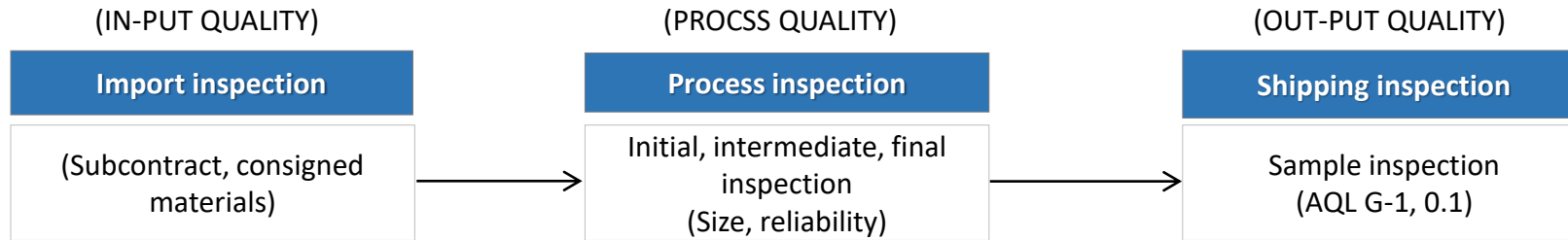

State of Quality Assurance

Emphasis is placed on enhancing quality competitiveness through quality compliance by stage and thorough verification from the design stage to manufacture and quality innovation. An integrated management and analysis system is being constructed that covers systematic process control, continuous process monitoring, statistical techniques, and company-wide proposals.

ISO9001:2015



IATF16949



MBE



UL



In process to get the National Minority Supplier



10.2. Metrology & test facilities

Equipment Status

- ❖ 3D Visual Measuring Machine (.0001" Tolerance) 2 set
- ❖ CMM from "Brown & Sharpe"
- ❖ CMM_Scan from "Wenzel"
- ❖ Push and Pull Tester
- ❖ Spectrophotometer
- ❖ Rubbing Tester
- ❖ Salt Spray Tester
- ❖ Thermal Shock chamber
- ❖ Tumbler Tester
- ❖ Vibrator Tester
- ❖ Light Booth
- ❖ MFI Tester
- ❖ Moisture Analyzer
- ❖ Temperature and Humidity chambers

Reliability tester (Items :)



(Thermal Hygrostat)



SPECTROPHOTO
METER

GLOSS METER



SALT SPRAY
TESTER



MELDED TESTER

Measuring tester

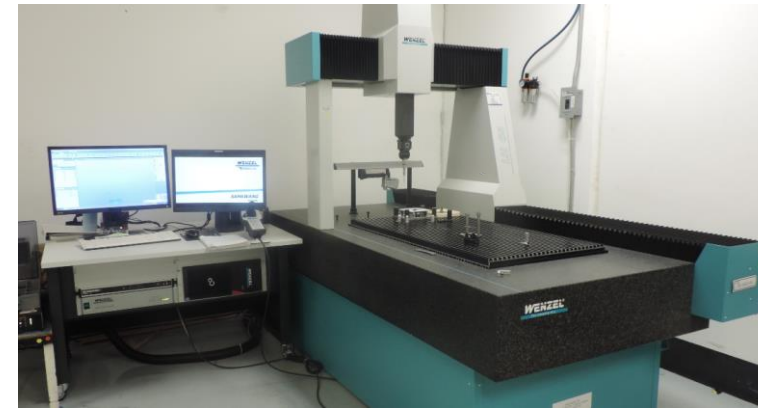

CMM-Wenzel LH65



VMM PMS 300

(Thermal Shock
Test Chamber)



CMM-BROWN
SHARPE

11. China SAMKWANG



Since establishing DG factory in March 2009, the factory has been steady revenue growth and become the largest partner of Samsung and Verifone within 4 years that makes successfully to build the most important production base of the global production network of Samkwang. Through contributing to job creation and economic development of communities, and social contribution activities, DG Samkwang is trying to do its best for corporate social responsibility corporate social responsibility.



Tooling



Injection, IMD



LSR



Painting



PVD



Press



Company Name	Dongguan Samkwang Science and Technology Limited Co.
Capital	\$ 1,600 Million
Founded on	March 19, 2009
Type of Business	Manufacturing
Company Type	Foreign Investment Company
Location	Euntae 3-ro, Eunho Industrial Complex, Sagangjin, Dongguan -si, Gwangdongseong, China
Building	74,200m ²
No. of Employees	4,870 Persons
Main Product	Plastic component
CAPA	6,000K Set / Month
Telephone	+86-769-8212-1901
F a x	+86-769-8212-1897

12. Vietnam SAMKWANG



SAMKWANG VINA has been established in 2018 to cooperate with SAMSUNG strategically.

SAMKWANG VINA is focusing on manufacturing for SAMSUNG now and growing rapidly.
New factory has a clean manufacturing environment, and SAMKWANG VINA are contributing to the revitalization of the economy of Bac Giang province.
As a corporation that will be in charge of SAMKWNAG's major sales in the future, based on the experience of Dongguan SAMKWANG, SAMKWANG is focusing all of its capabilities to be a NO.1 injection company in Viet Nam.



Factory



Tooling



Injection molding



Painting



Evaporation



Assembly



Company Name	SAMKWANG Vina Co., Ltd
Capital	\$ 300 Million
Founded on	2018. 5
Type of Business	Manufacturing
Company Type	Foreign Investment Company
Location	Lot U, Quang Chau Industrial Park, Quang Chau Commune, Viet Yen District, Bac Giang Province, Viet Nam
Building	40,000m²
No. of Employees	1,374 Persons
Main Product	Plastic component
CAPA	6,000K / Month
Telephone	+84-204-2484-122

13. Korea SAMKWANG



For the past 45 years, Samkwang has increased its production capacity and accumulated its technological know-how, constructing an integrated production system of diverse products, especially in manufacturing precision plastic parts. We are in possession of top quality facilities, technological know-how, and competent human talents. Based on this strength and thanks to our partnership with major makers of mobile phones, SAMKWANG is being recognized as an expert plastic parts company and we are intent on becoming one of the top ranking technology companies of the world through incessant creation and innovation



AUTOMOTIVE



PW PANEL Driver

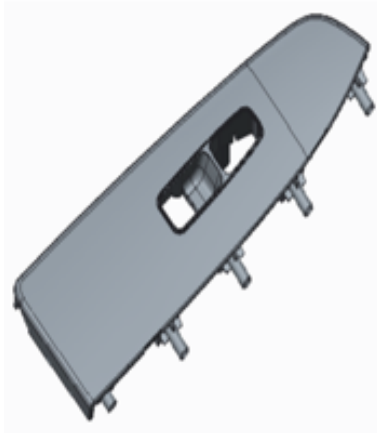

PW PANEL Passenger

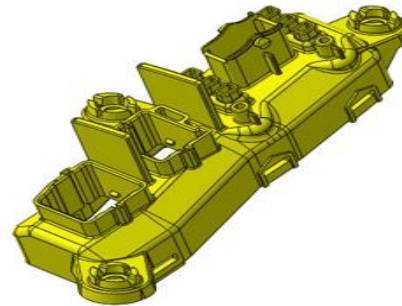

Body

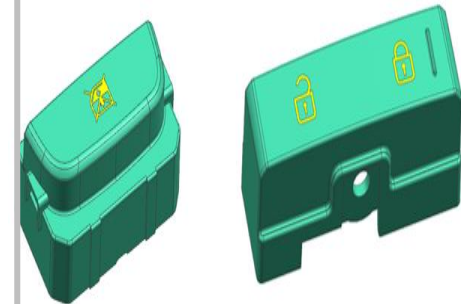

PW KNOB

StanleyBlack&Decker



PW PANEL Driver



Housing Motor

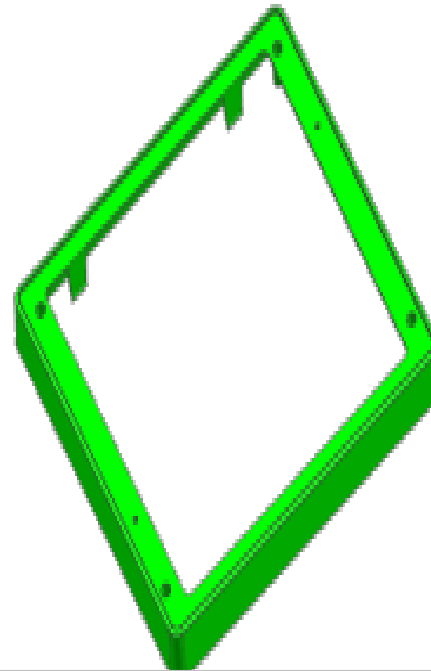

Cover Frame



Tag retail & Infusion, black
gray & red

15. Our current customers & potential



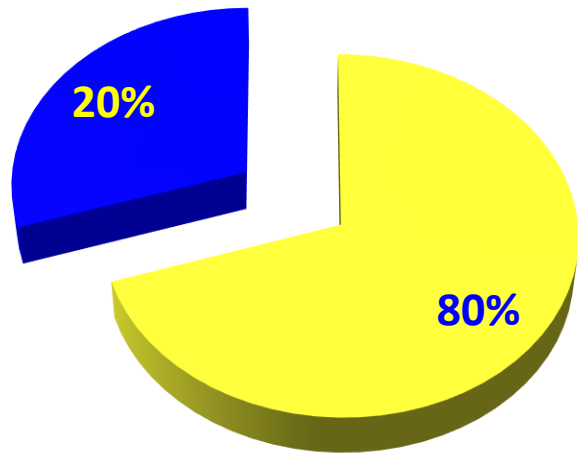

■ AUTOMOTIVE ■ CONSUMER

MAHLE

**For America Samkwang*

Makita

Mando



K
RAIN

MERIT



CTP
CENTRAL to Your Safe Mobility

kiekert

TW



TESLA



ISHER
Dynamics



AMETEK

Bissell

HILTI

VAST — **KOSTAL**
AUTOMOTIVE GROUP



GENTHERM



BOSCH
Technik fürs Leben



Yanfeng
Global Automotive Interiors

STRATTEC



KONGSBERG
AUTOMOTIVE

brose
Technik für Automobile



Solutions In Motion



SCOSCHE

16. Our current products in Reynosa



Automotive



17. Samkwang Reynosa Logistic

- ❖ Optimal proximity to USA
- ❖ Exits to Monterrey and Matamoros at immediate access.
- ❖ Quick response to issues
- ❖ DHL, EXEL, FEDEX, Freight Forwarders, Several Brokers.
- ❖ Efficient weekly, daily, hourly deliveries.
- ❖ 24 hours a day Engineering support (Reynosa / Korea)

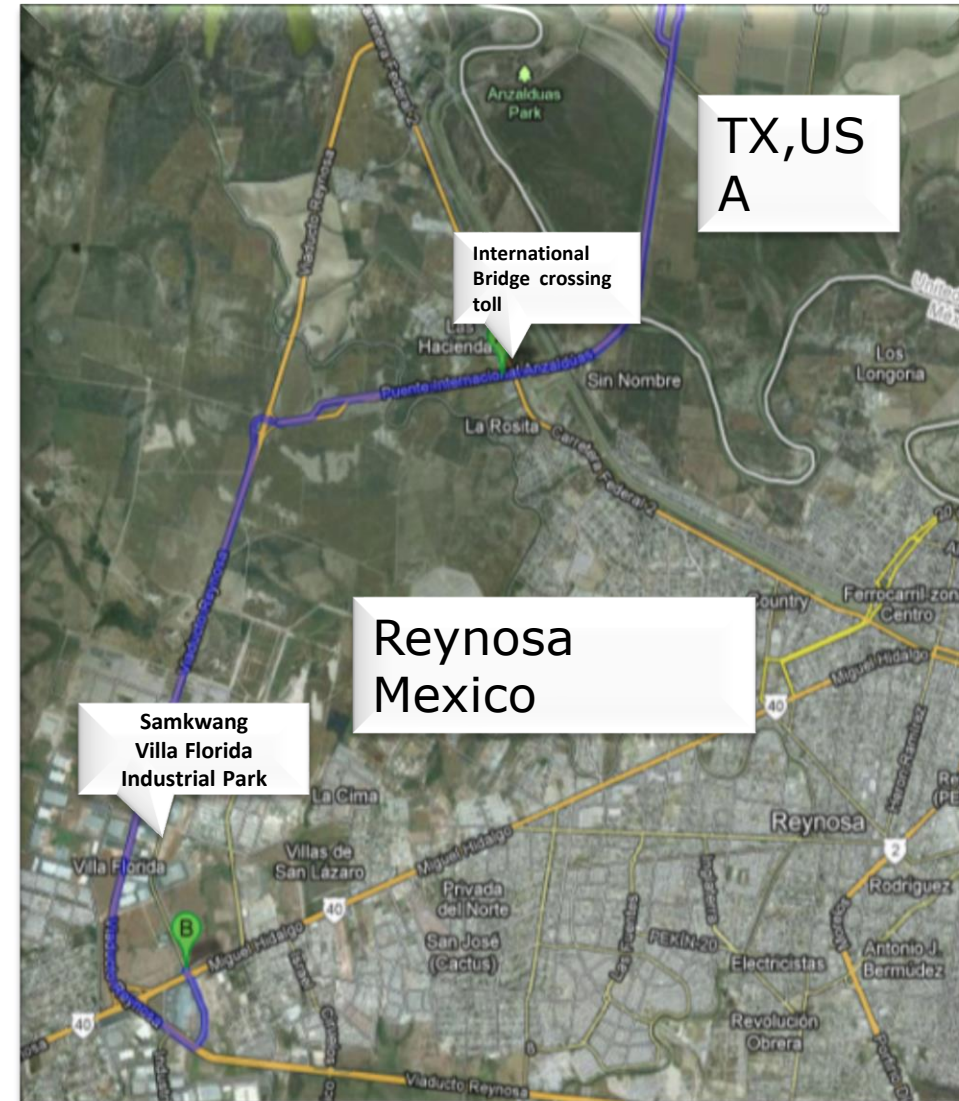

18. Tool Partner Capabilities (Korea)



C1UL

E2LB
SWITCH
PARK

K2XX
CADILLAC
BUTTON

K2XX GMC
BUTTON



18. Tool Partner Capabilities (Korea).. Molding design

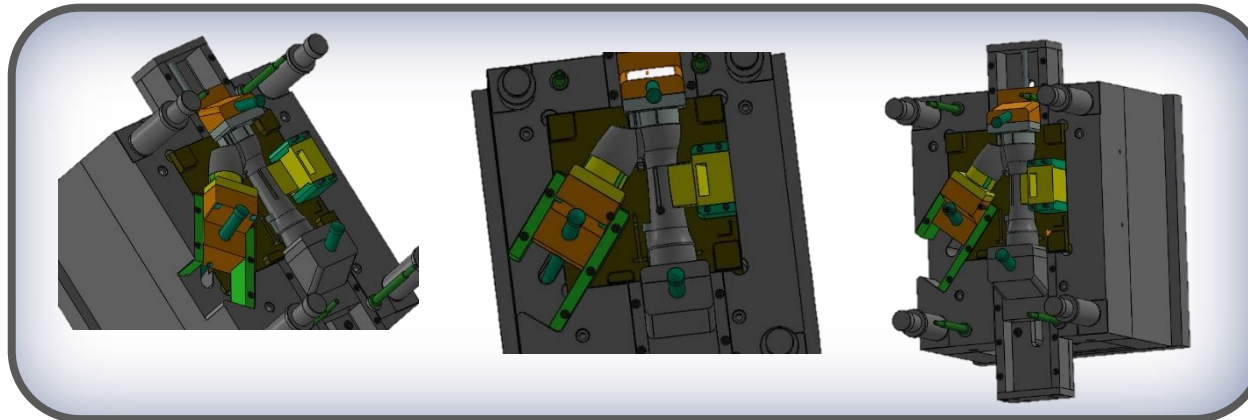
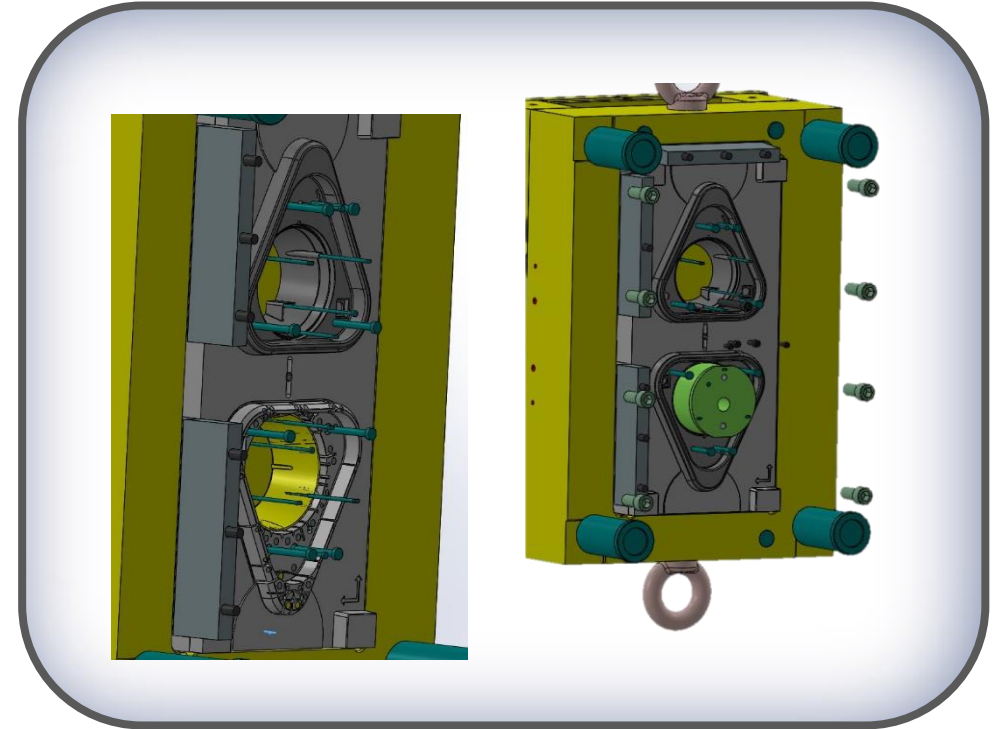
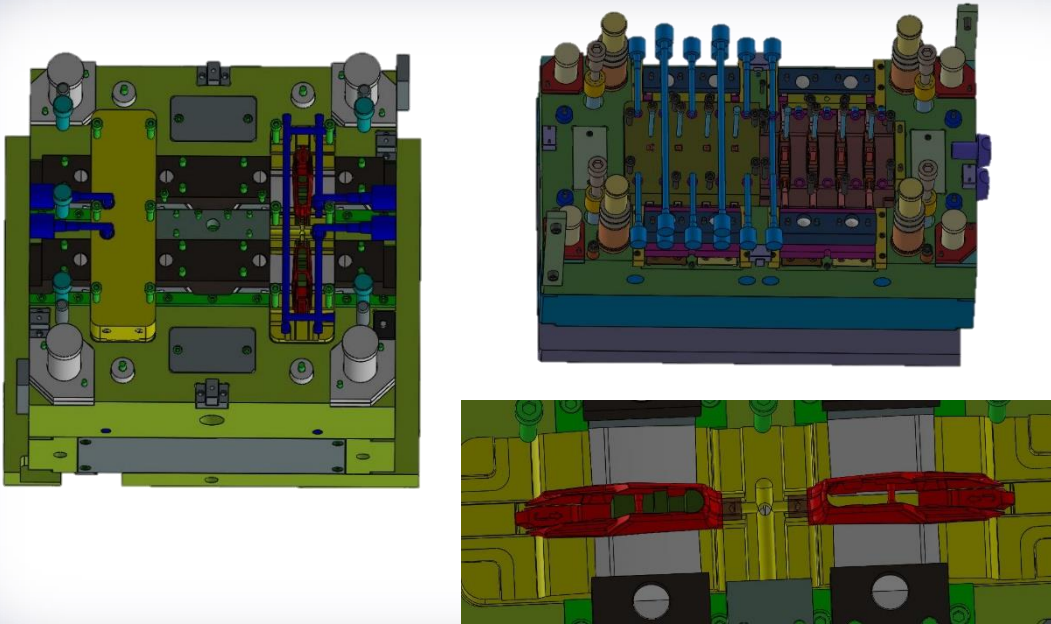

18. Tool Partner Capabilities Korea.- Decorative/Chroming Process



Outside Grip Handle



Inside Door Handle



Grill/Body Side/TailGate Molding



Indicator/Cupholder/Air Vent



DaeyangPlatech, Inc.



GarnishMolding



Foglamp/Garnish/Molding



Bezel/Steering Wheel Bezel



Nameplate



18. Tool Partner Capabilities (Korea).. Certification



Laser Etching
Two-Tone Plating



Electrodeposition
Painting Method



ISO14001

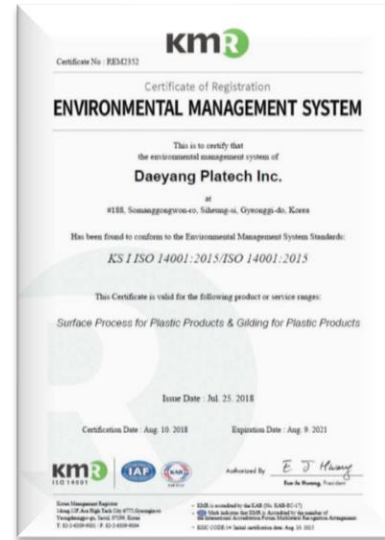

IATF16949



FIAT CRYSLER AUTOMOBILS (FCA)



BRIGHT CR (S20)

SATIN CR (S26)

PLATINUM CR (S27)

SQ MARK



RSM



GENERAL MOTORS (GM)



BRIGHT CR (150Z)

PEARL BRIGHT (110Z)

GARVANO SILVER (756S)

MATT SILKY GLOSS(908K)

TITANIUM CR (M24)

19. Advantages of Samkwang in Reynosa



- ❖ Reduce overall cost via continuous improvement:
- ❖ Yield Improvement
- ❖ Cycle time improvements
- ❖ Maximize equipment utilization
- ❖ Raw material Localization
- ❖ Local deliveries (OTD)
- ❖ One Stop Solution under one roof
- ❖ Tool design to Assembly with decoration process
- ❖ Engineering Support
- ❖ Local ESI team
- ❖ Work with Customers according to Local regional time.

Sales:

www.samkwangmx.com

Call Us! +1 (956) 686-0221

info@samkwangmx.com

*Our best **Goal**, is your satisfaction*



Thank You!
감사합니다!

***Best Family –Friendly
Management***